

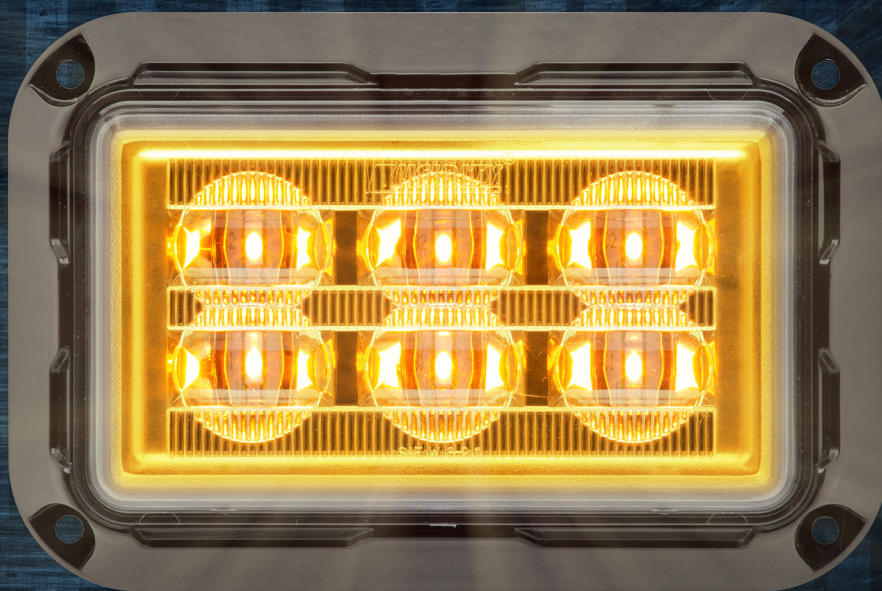

Better Value • Better Options • Better Lighting



DIRECTIONAL
WARNING
LAMPS

LED LIFETIME
WARRANTY

LED DIRECTIONAL WARNING LIGHTS

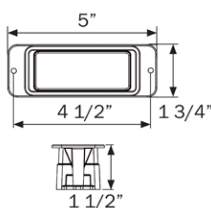
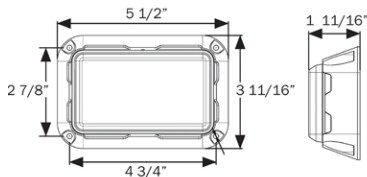
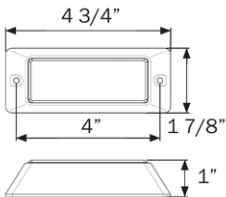

SLL22 Series

Sync Capable Flash Patterns: random, steady, single, mega, double, triple, quad, quint, 8-flash, single-quad, single h/l and single-triple-quint

- Tough black ABS housing and polycarbonate lens
- Surface mount, gasket included
- 12 flash patterns
- Hard wired: 4-wire, 7" leads
- IP67 rating
- Sonically sealed, waterproof

BULK P/N	POLYPACK P/N	DESCRIPTION	VOLTAGE RANGE	DIODES	CASE QTY
SLL22ACB	SLL22ACBP	Yellow	9-36VDC	3 SMD	1
SLL22CB	SLL22CBP	White	9-36VDC	3 SMD	1

MATERIALS	Polycarbonate lens, Black ABS	VOLT/AMP	13.5VDC - 0.45A
WEIGHT	0.22 lbs.	WARRANTY	Lifetime LED Warranty
DIMS	4.70" W x 1.84" H x 1.04" D	FMVSS	Yellow: SAE J845, Class II

SLL51 Series

Sync Capable Flash Pattern: five-flash

- Tough black ABS housing and polycarbonate lens
- Surface mount, gasket included
- 12 flash patterns
- Hard wired: 3-wire, 72" leads
- IP67 rating
- Sonically sealed, waterproof

BULK P/N	POLYPACK P/N	DESCRIPTION	VOLTAGE RANGE	DIODES	CASE QTY
SLL51ACB	SLL51ACBP	Yellow	9-36VDC	6 SMD	1
SLL51CB	SLL51CBP	White	9-36VDC	6 SMD	1

MATERIALS	Polycarbonate lens, Black ABS	VOLT/AMP	13.5VDC - 0.33A
WEIGHT	0.49 lbs.	WARRANTY	Lifetime LED Warranty
DIMS	5.54" W x 3.67" H x 1.67" D	FMVSS	Yellow: SAE J845, Class II

SLL80 Series

Sync Capable Flash Patterns: random, triple-alt, single, mega, double, triple, quad, quint, 8-flash, single-quad, single h/l and single-triple-quint

- Tough black ABS housing and polycarbonate lens
- Recess mount, gasket included
- 12 flash patterns
- Hard wired: 4-wire, 7" leads
- IP67 rating
- Sonically sealed, waterproof

BULK P/N	POLYPACK P/N	DESCRIPTION	VOLTAGE RANGE	DIODES	CASE QTY
SLL80ACB	SLL80ACBP	Yellow	9-36VDC	6 SMD	1
SLL80CB	SLL80CBP	White	9-36VDC	6 SMD	1

MATERIALS	Polycarbonate lens, Black ABS	VOLT/AMP	13.5VDC - 1.3A
WEIGHT	0.26 lbs.	WARRANTY	Lifetime LED Warranty
DIMS	4.92" W x 1.73" H x 1.47" D	FMVSS	Yellow: SAE J845, Class II

Sync Capable Flash Patterns: random, triple-alt, single, mega, double, triple, quad, quint, 8-flash, single-quad, single h/l and single-triple-quint

SLL81 Series

- Tough black ABS housing and polycarbonate lens
- Surface mount, gasket included
- 12 flash patterns
- Hard wired: 4-wire, 7" leads
- IP67 rating
- Sonically sealed, waterproof

BULK P/N	POLYPACK P/N	DESCRIPTION	VOLTAGE RANGE	DIODES	CASE QTY
SLL81ACB	SLL81ACBP	Yellow	9-36VDC	6 SMD	1
SLL81CB	SLL81CBP	White	9-36VDC	6 SMD	1

MATERIALS	Polycarbonate lens, Black ABS	VOLT/AMP	13.5VDC - 1.3A
WEIGHT	0.27 lbs.	WARRANTY	Lifetime LED Warranty
DIMS	4.36" W x 1.69" H x 1.55" D	FMVSS	Yellow: SAE J845, Class II

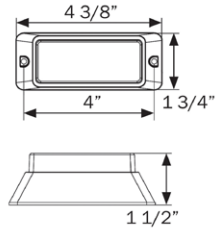

Sync Capable Flash Patterns: random, steady, single, mega, double, triple, quad, quint, 8-flash, single-quad, single h/l and single-triple-quint

SLL60 Series

- Tough aluminum housing and polycarbonate lens
- Surface mount
- 12 flash patterns
- Hard wired: 4-wire, 72" leads
- IP67 rating
- Sonically sealed, waterproof



BULK P/N	POLYPACK P/N	DESCRIPTION	VOLTAGE RANGE	DIODES	CASE QTY
SLL60ACB	SLL60ACBP	Yellow	9-36VDC	9 SMD	1

MATERIALS	Polycarbonate lens, Aluminum	VOLT/AMP	13.5VDC - 0.77A
WEIGHT	3.38 lbs.	WARRANTY	Lifetime LED Warranty
DIMS	15.66" W x 3.58" H x 2.43" D	FMVSS	SAE J845, Class II

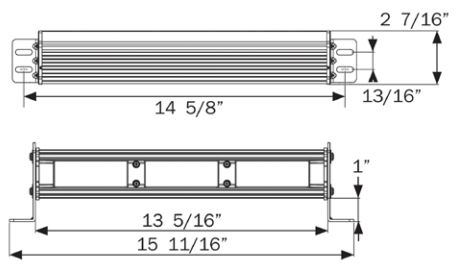

LED LIFETIME WARRANTY

No-hassle, one-diode warranty covers ALL Optronics LED lights.



- Surface Mount Device
- Fewer connection points, fewer corrosion points
- Automated manufacturing for consistent quality
- Thinner, more compact designs fit more applications

IP67 RATING

Protected from dust and capable of withstanding water immersion, offering increased reliability and service life.



For more information, scan this QR code with your mobile device
www.optronicsinc.com